

- de** Montageanleitung
- en** Mounting instructions
- fr** Instructions de montage
- sv** Monteringsinstruktion
- nl** Montage-aanwijzing
- it** Istruzioni di montaggio
- fi** Asennusohje
- es** Instrucciones de montaje
- da** Monteringsvejledning
- tr** Montaj talimatları

## QPM11.. QPM21..

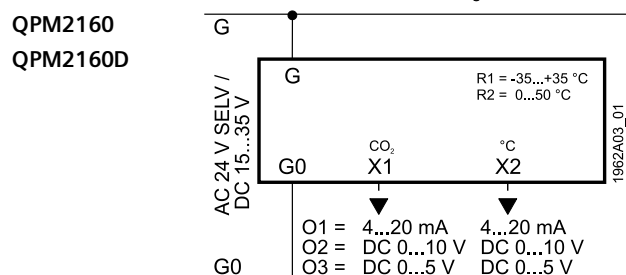

**QPM1160**

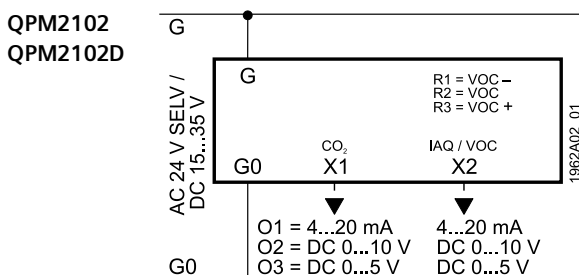
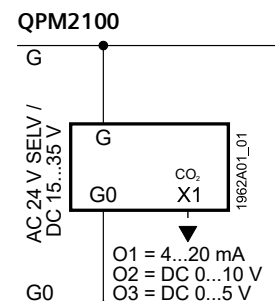
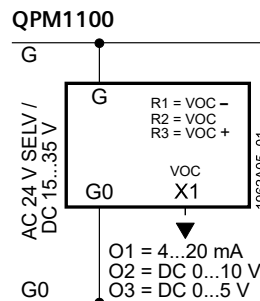
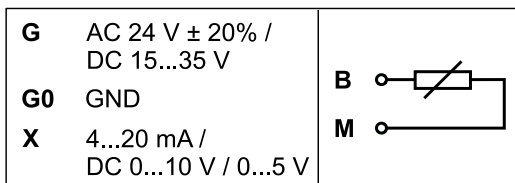
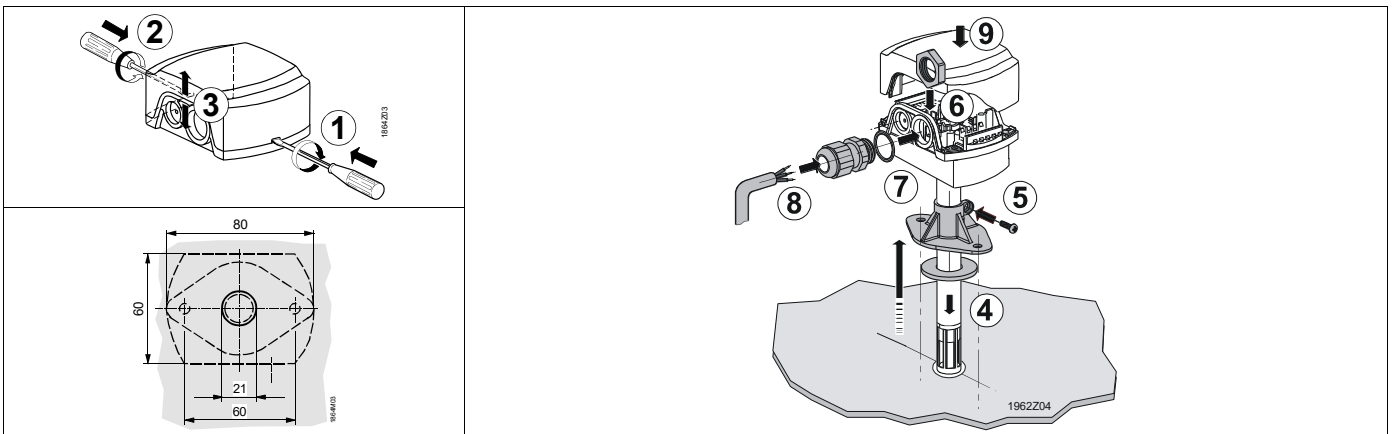
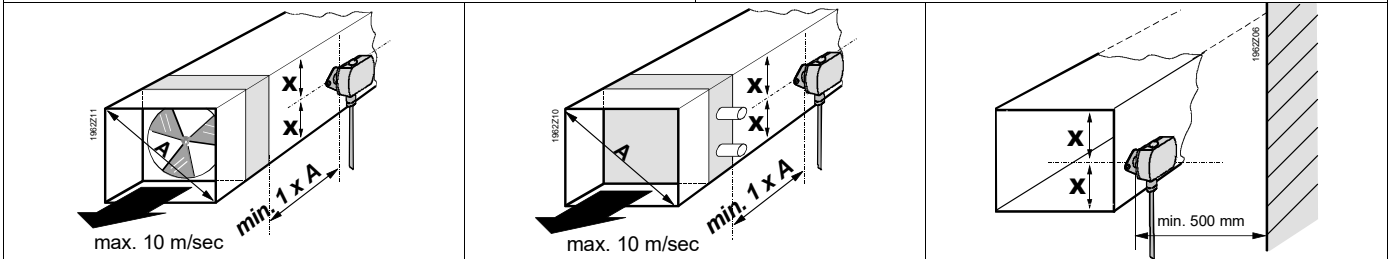
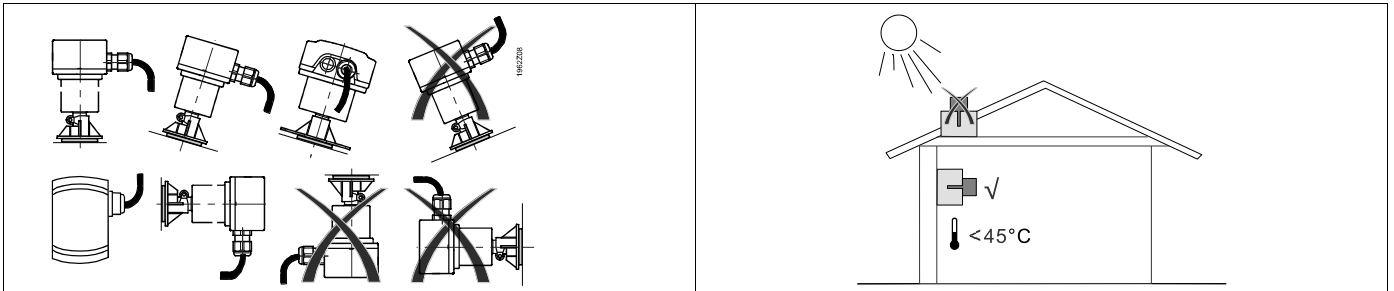
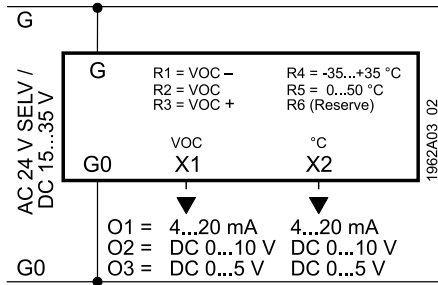

**QPM1162**

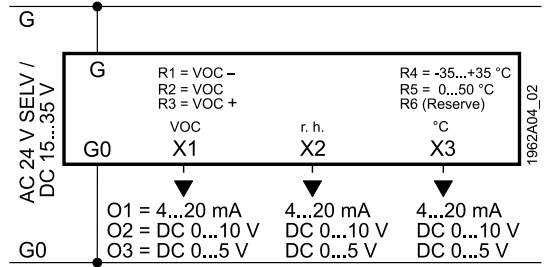

**QPM2162**  
**QPM2162D**

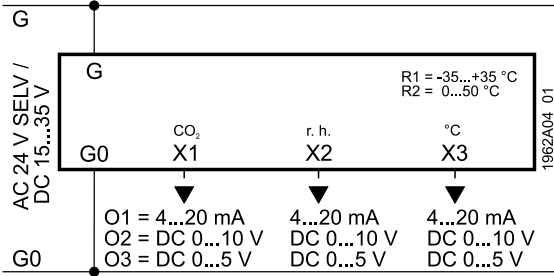

**QPM2180**

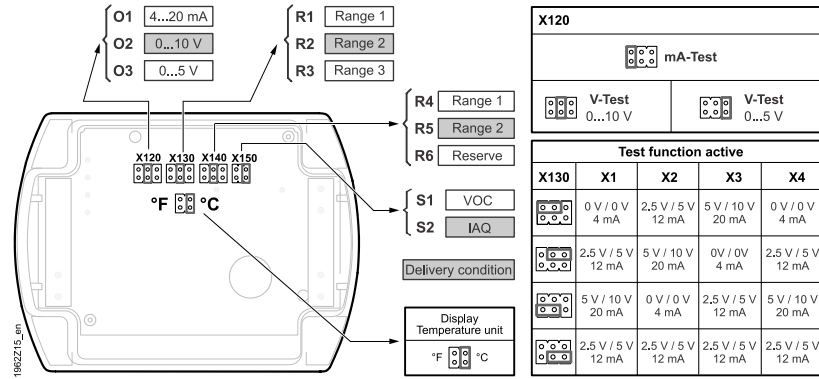
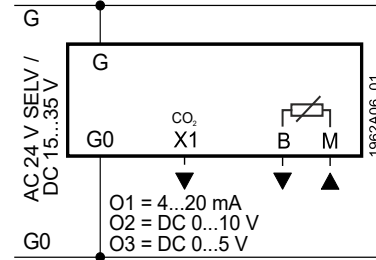

**QPM2163**

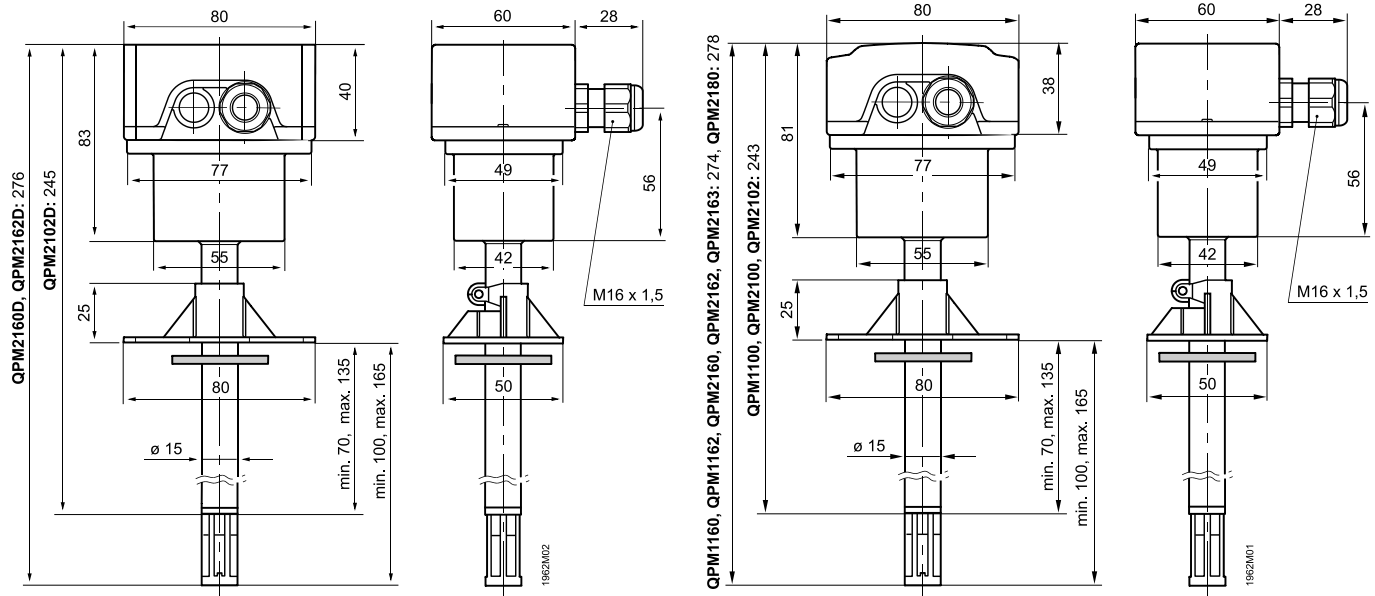
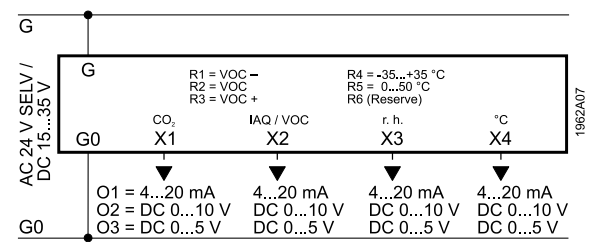

Masse in mm    Dimensions en mm    Mål i mm    Afmetingen in mm    Mitat mm  
Dimensions in mm    Dimensiones en mm    Mått i mm    Dimensioni in mm    Boyutlar mm

**Open Source Software (OSS)**

All open source software components used within the product (including their copyright holders and the license conditions) can be found from the website <https://www.siemens.com/download?A6V12393975>.

Issued by  
Siemens Switzerland Ltd  
Smart Infrastructure  
Global Headquarters  
Theilerstrasse 1a  
CH-6300 Zug  
Tel. +41 58 724 2424  
[www.siemens.com/buildingtechnologies](http://www.siemens.com/buildingtechnologies)

© Siemens Switzerland Ltd, 2005  
Technical specifications and availability subject to change without notice.